

**PLASPLUGS® Compact™**

# Drill Sharpener Plus!

**4 sharpeners in one pack**

## High Speed Steel Drill Sharpener

- Sharpens all HSS drill bits 3mm to 10mm dia.



## Masonry Drill Sharpener

- For standard & hammer action bits to 10mm dia.



## Chisel & Plane Sharpener

- Blades up to 50mm wide
- Adjustable angle 20° - 80°



## Knife & Scissor Sharpener

- For straight edge blades



**FOR YOUR SAFETY. PLEASE READ BEFORE USE.**

# Instruction Manual

## SET INCLUDES:

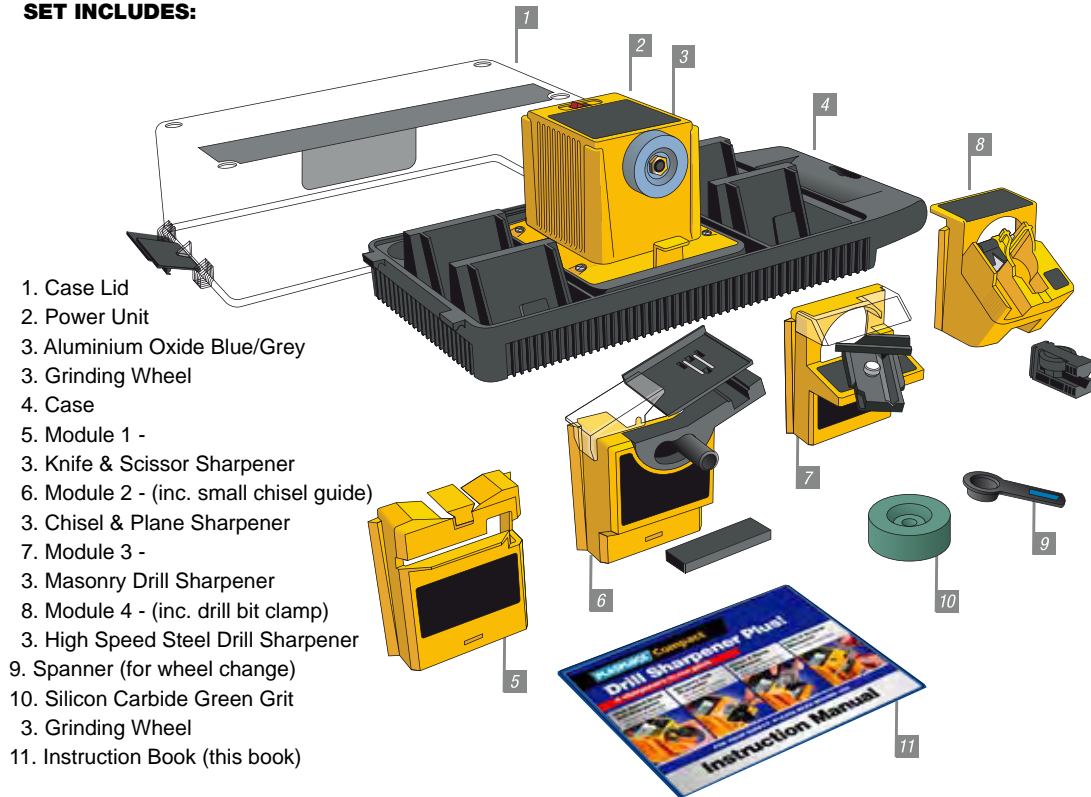

## ATTACHING, REMOVING & STORING THE MODULES

To attach a module guide, slide it fully down the slots on the front of the Power Unit – it will automatically latch into place (c). Do not attach a module when the grinding wheel is moving. **Never use the grinding wheel without a module in place.**

## SETTING UP THE POWER UNIT

The Power Unit should only be used on a stable, horizontal surface. It is intended to be used either screwed into the carry case or, if removed from the case, screwed to a workbench (a) Use 4 one inch No 8 counter sunk screws for this purpose.

## CHANGING THE GRINDING WHEEL

1. To change the grinding wheel, remove existing wheel by turning reverse thread nut clockwise with spanner (b).
2. Locate new wheel on drive shaft lugs. Replace wheel and tighten turning nut anti-clockwise. **Do not over tighten.**

To remove a module, press the release catch down and slide the module up (d). Before removing, always switch the Power Unit off and let the grinding wheel stop – this takes approximately 10 seconds.

When not using the 4 in One Power Sharpener, store the modules in the slots in the carry case. During use, remove all additional modules to keep the working area clean.)

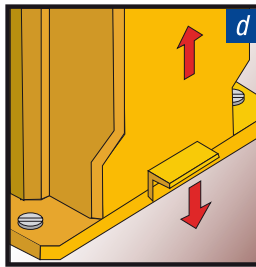
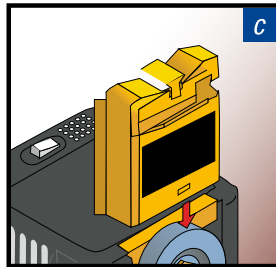
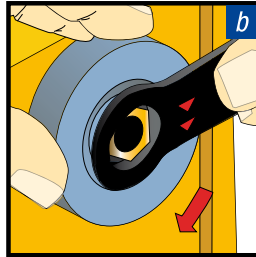
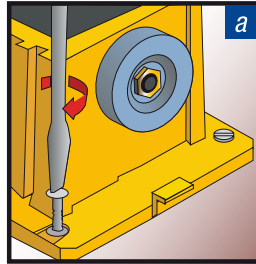

**PLEASE READ CAREFULLY ALL THE FOLLOWING SAFETY PRECAUTIONS PRIOR TO USING YOUR COMPACT DRILL SHARPENER PLUS FOR THE FIRST TIME**

## USER PRECAUTIONS

- Remove all loose clothing, neckties, rings, bracelets and other jewellery that may get caught in moving parts.
- Non-slip footwear is recommended.
- Wear protective hair covering to contain long hair.
- Ear muffs and gloves are recommended.
- Always use safety glasses. NB: Everyday eye glasses do not contain impact resistant lenses – they are NOT safety glasses.
- Always use face or dust masks if grinding operation is dusty.

## CARE AND CLEANING

- Before cleaning, disconnect from the mains.
- Keep clean and free from oil and grease.
- Store in dry conditions.



When using electrical tools, basic safety precautions should always be used including the following:

- Unplug from outlet when not in use, before putting on or taking off any parts and before cleaning.
- To protect against electrical shock, do not immerse cord, plug or appliance in water or any other liquid.
- To reduce the risk of unintentional starting, make sure that the switch is in the off position before plugging in.
- Do not operate any product with a damaged cord or plug, if the product malfunctions or it is dropped or damaged in any way.
- Always check for damaged parts before operation. Damaged parts should be properly repaired and replaced.
- Do not use in dangerous environments or expose to damp or wet conditions.
- Keep your working area well lit.
- Do not let the cord hang over the edge of table or counter or touch hot surfaces.
- Do not use product or attachments for other than intended purpose.
- Do not leave the grinding wheel unattended whilst it is operating.
- Keep all non-users a safe distance from the work area. Keep out of reach of children at all times.
- Grinding generates sparks – keep away all flammable substances and materials.
- Never touch the moving grinding wheel.
- The motor is specially rated for intermittent use – maximum 20 minutes continuous use.
- Do not attach modules when the grinding wheel is moving.
- Do not use the grinding wheel without a module in place.
- Before removing a module, switch off on the Power Unit and allow the grinding wheel to come to a stop

## High Speed Steel Drill Sharpener

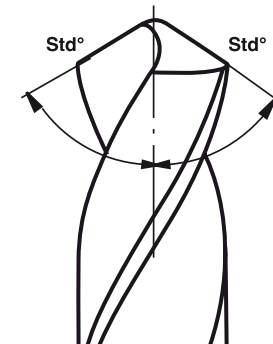
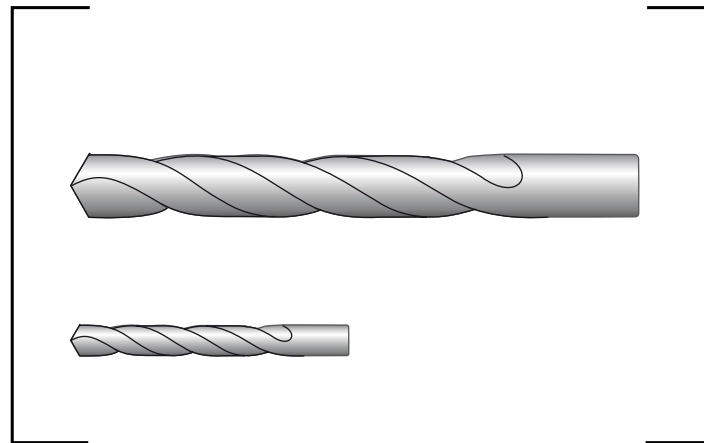

### WHEEL TYPE:

**USE THE ALUMINIUM OXIDE BLUE/GREY GRINDING WHEEL**

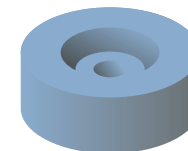

- 1 Clamp
- 2 HSS Drill bit
- 3 'V' Guide

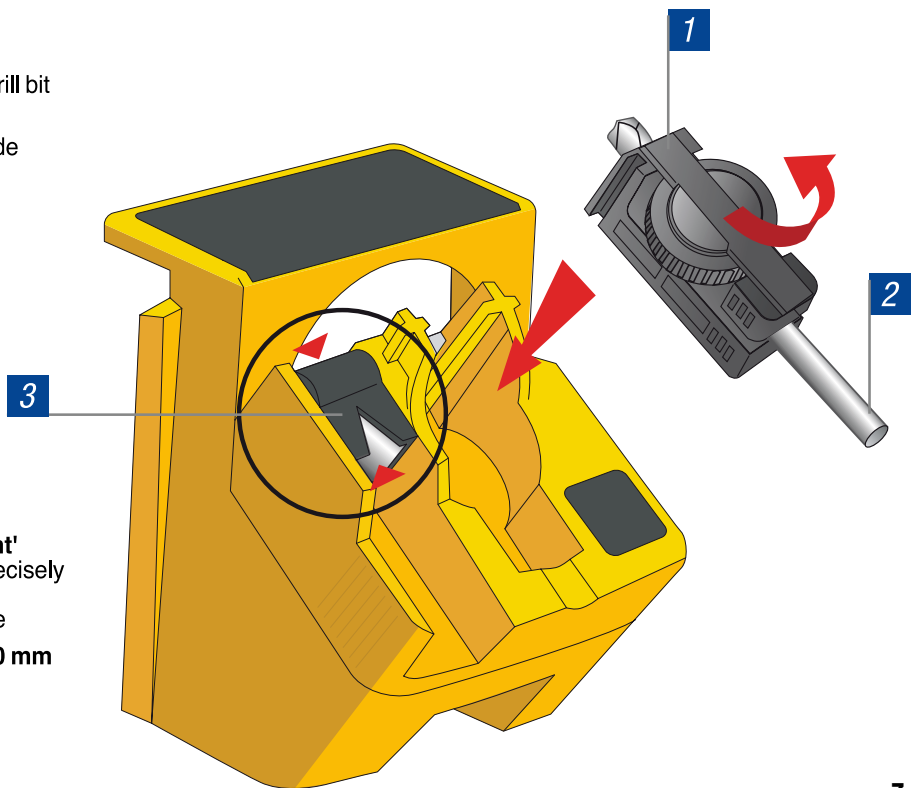

- **'True Point'** action for precisely sharpening correct angle
- For 3 to 10 mm dia. drills

## 1 SHARPENING HSS BITS

Use the aluminium oxide blue/grey grinding wheel. Suitable for all HSS drill bit sizes between 3mm and 10mm diameter. Do not use with masonry or hammer drill bits.

1. Slide module 4, labelled High Speed Steel Drill Sharpener, onto the Power Unit.
2. Remove the clamp from the clamp holder and insert the drill bit to be sharpened (4a). Tighten the clamp lightly to leave the drill bit still free to move.
3. Place the clamp containing your drill bit into the setting slot, using the grooves in the side to lower it in correctly (4b).
4. Move the drill bit forward so that it lays in the 'V' guide and touches the metal end stop (4c).
5. Turn the drill bit until the V guide fully drops over it (4c) – all four drill bit corners should now be touching the V guide sides.

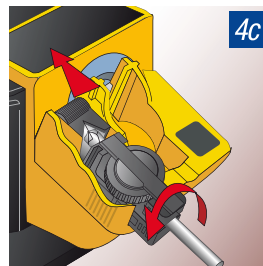
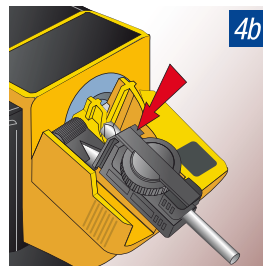

6. Ensure that the drill and holder are fully down in the setting slot. With the drill bit in this position, tighten the clamping ring (4d).
7. Lift up the 'V' Guide and remove the clamp and drill bit.
8. Transfer the clamp and drill bit into the clamp holder on the Power Unit module (4e).
9. Switch the Power Unit on.
10. Move the clamp holder from side to side, securing with light finger pressure (4f).
11. Remove the drill bit and holder and turn over (4g). Repeat No.11.
12. Check the leading edge of both flutes are equally sharp and that the tip is "backed off" equally on both sides – they should meet exactly in the middle as in (4h), not (4i).
13. Switch the Power Unit off. Before removing the module, ensure the grinding wheel has stopped.

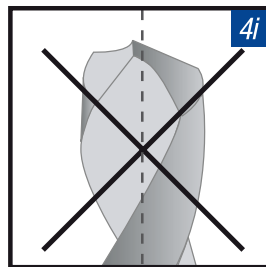
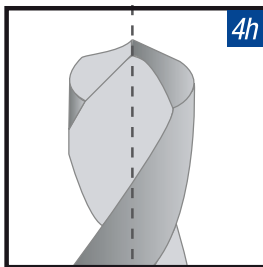
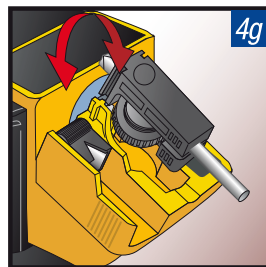
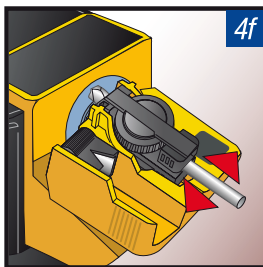
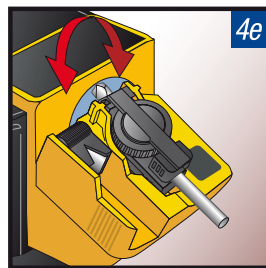
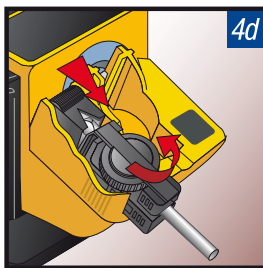

9

## Masonry Drill Sharpener

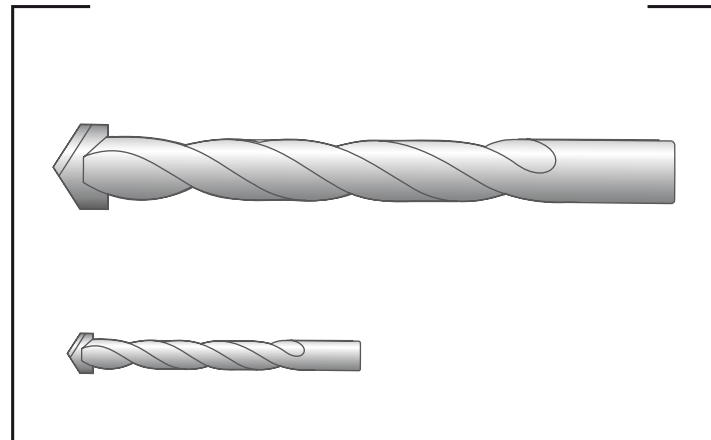

### WHEEL TYPE:

**USE THE SILICON CARBIDE GREEN  
GRIT GRINDING WHEEL**

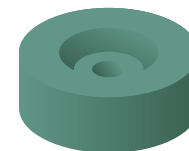

- 1 Protective shield for added safety
- 2 Bridge channel for Hammer drill bits
- 3 Bridge channel for Masonry drill bits

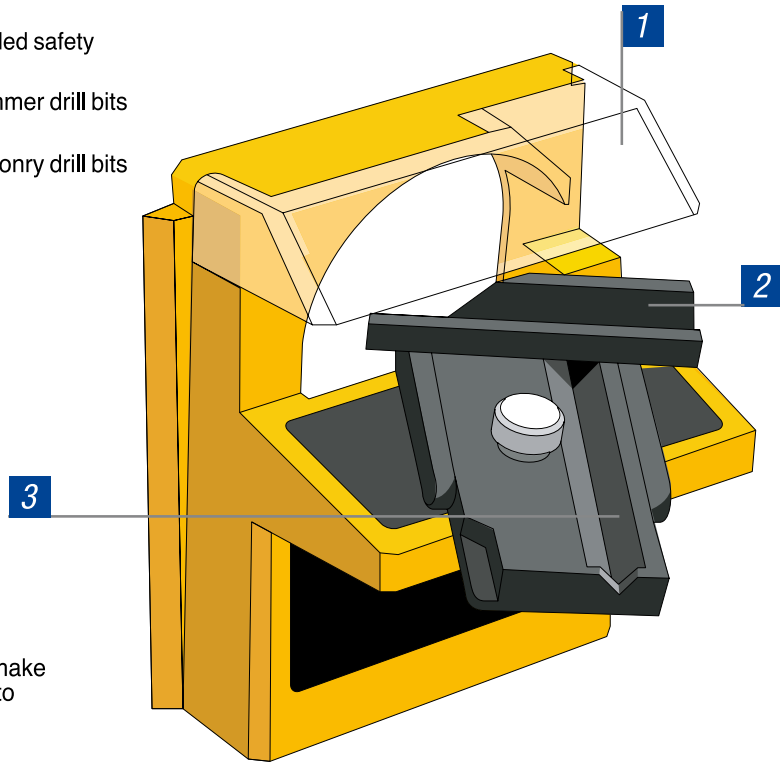

Drill alignment guides make re-sharpening drill tips to accurate angles quick and easy

## 1 SHARPENING MASONRY BITS

Use the silicon carbide green grit grinding wheel.

1. To change the grinding wheel, remove existing wheel by turning reverse thread nut clockwise with spanner.
2. Locate new wheel on drive shaft lugs. Replace wheel and tighten turning nut anti-clockwise. Do not over tighten.
3. When new, remove knurled bolt, locate the drill guide on the module and replace the bolt.
4. Slide module 3, labelled masonry drill sharpener, onto the Power Unit (3a).
5. Lift up the clear guard and swing back the bridge (3b). Position drill on drill channel holder. Ensure drill tip lays flat in channel.
6. The sharpening angle must match the existing drill tip angle. Adjust if necessary. To alter the angle loosen the adjustment knob (3c), adjust drill channel holder angle – then tighten

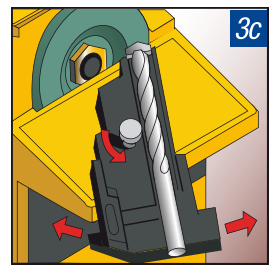
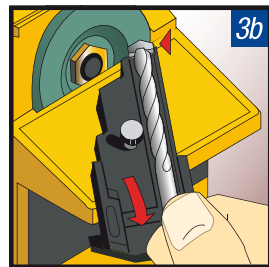
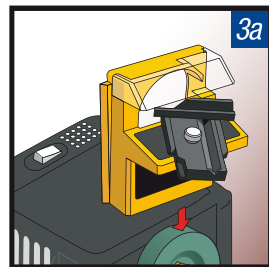

7. Replace clear guard and hold the drill bit so the tip touches the grinding wheel (3d).
8. Switch the Power Unit on.
9. Use light steady pressure for 5 seconds to sharpen tip. Do not press hard. Turn drill over to sharpen other side of tip as above. Check both sides are sharp and that they meet in the middle (3e).
10. Switch the Power Unit off. Before removing the module, ensure the grinding wheel has stopped.

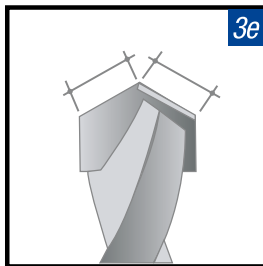
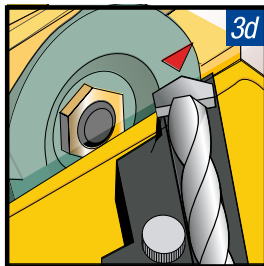

## 2 SHARPENING HAMMER DRILLS

1. Hammer Drills need to be “backed off”. Lift guard and swing bridge forward and locate drill in bridge channel. Ensure drill tip lays flat in locating slot (3f).
2. Replace guard and switch the Power Unit on using light pressure to grind off small chamfer from edge of tip (3g).
3. Switch the Power Unit off. Before removing the module, ensure the grinding wheel has stopped.

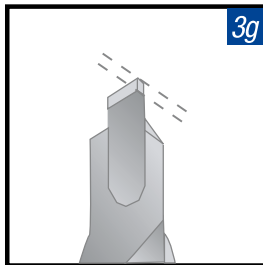
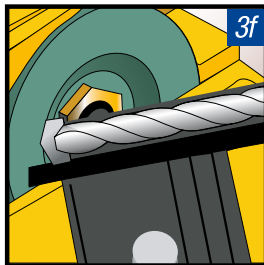

# Chisel & Plane Sharpener

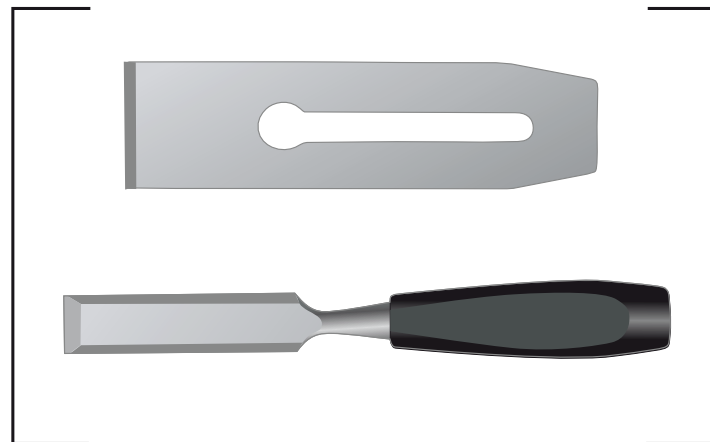

- For blades up to 50mm wide
- Angle adjustable from 20° to 80°
- Magnetic bed & safety shield

### WHEEL TYPE:

**USE THE ALUMINIUM OXIDE BLUE/GREY GRINDING WHEEL**

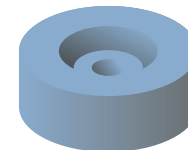

1 Protective shield for added safety

2 Powerful integral magnet to keep blade secure

3 Adjustable grinding angle  
from 20 to 80 degrees

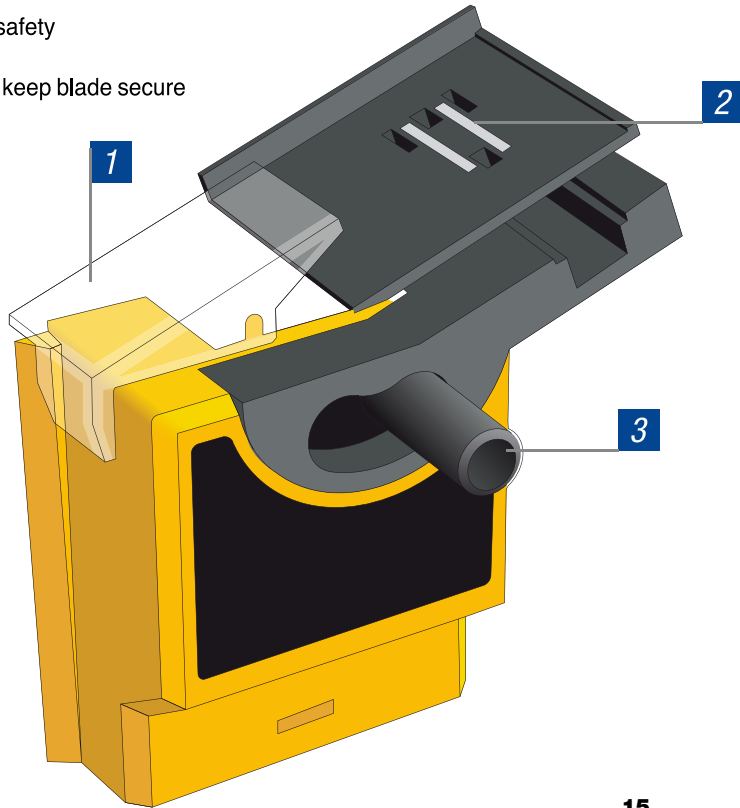

## 1 SHARPENING BLADES

Check the blade edge touches the grinding wheel, then switch the Power Unit on. channel. Ensure drill tip lays flat in locating slot (3f).

2. Replace guard and switch the Power Unit on using light pressure to grind off small chamfer from edge of tip (3g).

3. Switch the Power Unit off. Before removing the module, ensure the grinding wheel has stopped.

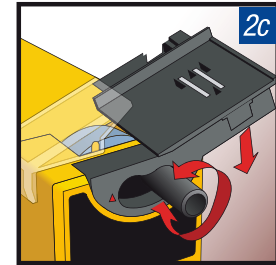
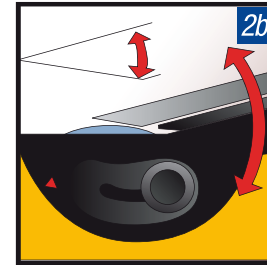
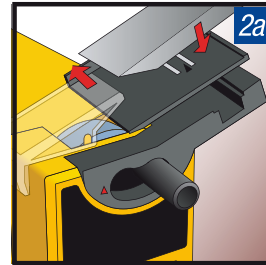

6. Slide the blade and plate with light steady pressure back and forth across the grinding wheel in a continuous motion (2d). Do not hold the blade stationary – this causes irregular sharpening.

7. Gradually adjust the blade down the plate whilst sharpening (2e). Do not press hard – grind gradually, repeating the action.

8. Remove the blade and check the bevelled edge and tip are evenly sharp. If not, finely adjust the grinding angle. It is important that the sharpening angle matches the existing bevelled angle of the blade. This avoids removing too much metal unnecessarily and keeps plane blades at their optimum shaving angle (2f).

9. When sharpening thin chisel blades, place the small chisel guide on to the plate to act as a spacer, and sharpen as before.

10. Switch the Power Unit off. Before removing the module, ensure the grinding wheel has stopped.

11. Plasplugs recommend that after grinding, the blade tip is honed on an oil stone.

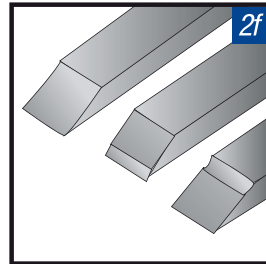
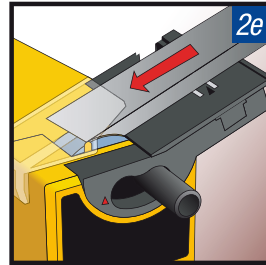
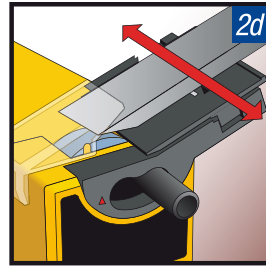

17

## Knife & Scissor Sharpener



- This module is suitable for all straight edge, household knives. Do not use with serrated edged blades
- Suitable for all household straight edged scissors. Do not use with serrated, wavy edged blades or pinking shears

### WHEEL TYPE:

**USE THE ALUMINIUM OXIDE BLUE/GREY GRINDING WHEEL**

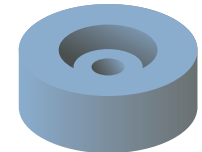

18

1 Top guide slot for knives

2 Front guide slot for scissors

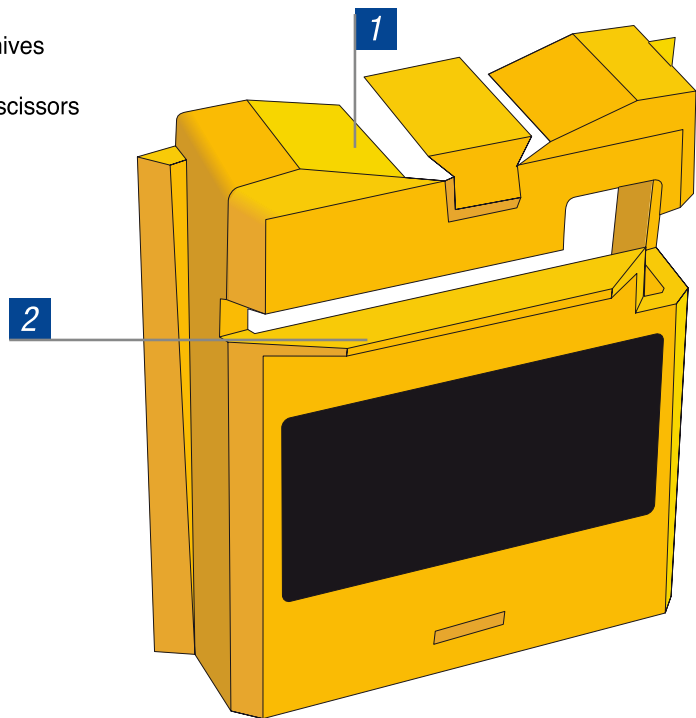

- For all straight edge blades
- Top & front guides for precise angle sharpening

## 1 SHARPENING KNIVES

Use the aluminium oxide blue/grey grinding wheel. This module is suitable for all straight edge, household knives. Do not use with serrated edged blades.

1. Slide module 1, labelled Knife & Scissor Sharpener, onto the Power Unit.
2. Switch the Power Unit on.
3. Hold the knife handle towards you and insert the handle end of the blade into guide slot (1a).
4. As soon as the blade touches the grinding wheel, draw it with light steady pressure across the wheel to the tip – then remove. Do not press hard (1b).
5. Insert the second side of the blade into the other top guide slot (1c) and repeat as in step 4.
6. Repeat sharpening each side in turn until a clean sharp edge is attained.
7. Switch the Power Unit off. Before removing the module, ensure that the grinding wheel has stopped.

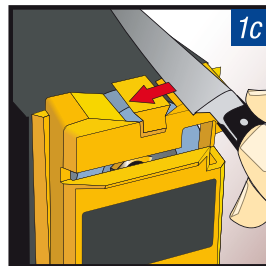
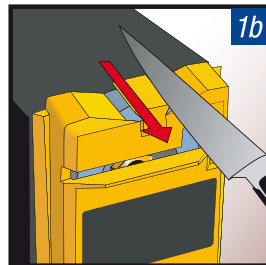
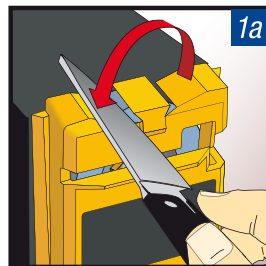

Use the aluminium oxide blue/grey grinding wheel. Suitable for all household straight edged scissors. Do not use with serrated, wavy edged blades or pinking shears.

1. Slide module 1, labelled Knife & Scissor Sharpener, onto the Power Unit.
2. Switch the Power Unit on.
3. Open the scissors fully.
4. Slide the first scissor blade through the front guide slot (1d) – keep the pivot of the scissors and other blade to right hand side.
5. Draw the blade across the grinding wheel from pivot to tip. Use a light steady pressure, do not press too hard (1e).
6. Remove and turn scissors over to sharpen the second blade (1f) – keep the pivot to the right and sharpen from pivot to tip.
7. Repeat if necessary, until clean sharp edges are achieved.
8. Switch the Power Unit off. Before removing the module, ensure that the grinding wheel has stopped.

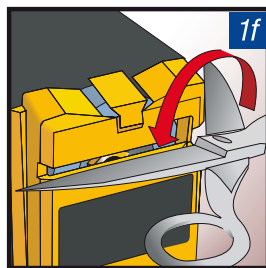
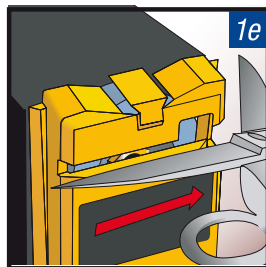
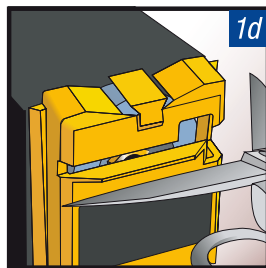

## Guarantee

Your Plasplugs product is guaranteed for one year from date of purchase, against electrical and mechanical defects in material and workmanship. Repairs or part replacement required as a result of such defects will be made free of charge during this period. Proof of purchase must be provided.

This guarantee does not cover damage caused by misuse, negligence or use on current or voltage other than that stamped on the product. The guarantee is invalid if the machine has been dismantled or interfered with in any way and persons other than Plasplugs consumer care department have attempted repairs.

This guarantee is in lieu of any other warranty expressed or implied. This warranty does not affect your statutory rights.

The power cable on this unit should only be repaired by Plasplugs Ltd or another qualified electrician.

### Technical Information

230V - 50Hz  
70W - 70Db  
Conforms to IPX4



Waste electrical products should not be disposed of with household waste. Please recycle where facilities exist. Check with your local authority or retailer for recycling advice.

For after sales care or any other additional questions you may have regarding Plasplugs DIY product range, please contact our free-phone number on 0800



Plasplugs Ltd Wetmore Road Burton on Trent Staffordshire DE14 1SD UK  
Tel: +44 (0)1283 530303 Fax: +44 (0)1283 531246 [www.plasplugs.com](http://www.plasplugs.com)

© 2004 Plasplugs Ltd

Due to minor changes in design or otherwise, the product you buy may differ slightly from the one shown in this manual. Approved by EEC Standards.

Plasplugs Ltd declares that the Compact Drill Sharpener Plus (Ref: DSF425) conforms to safety standard IPX4

Part No: 062506301